



Patented ColorSave® technology - one step ahead in Precise Masterbatch Metering for injection molding and extrusion machines

ColorSave 1000

Highly advanced and cost-effective single component gravimetric masterbatch/additive feeder for injection-molding machines

- *Up to 50% savings in masterbatch/additives consumption when compared to volumetric feeder*
- *Up to 35% savings in masterbatch/additives consumption when compared to remote batch blender*
- *Up to 15% savings masterbatch/additives consumption when compared to batch blender on machine throat*



Advantages and Features

- Extreme accuracy and repeatability allows precise dosing and prevents overdosing of materials
- Loss-in-weight controlling function allows optimum adjustment of operating point
- Improved final product quality
- Reduced number of rejects
- Very simple operation with automatic calibration (zero setup time) ensures maximal efficiency
- Consistent delivery of shot weight, unaffected by particles geometry or their free-flowing properties
- Real-time data collection and management of masterbatch consumption using proprietary control software
- Innovative design and algorithms ensure excellent resistance to mechanical shocks and vibrations
- Integrated automatic venturi vacuum loader
- Easy replacement of feeding screw
- Easy maintenance and cleaning when switching colors
- Compact mechanical design and low hopper profile, suited to any injection machine

ColorSave 1000 versus Volumetric Dosing

Due to higher accuracy and lower tolerances of the ColorSave 1000 in comparison to volumetric systems, a lower working set-point (%) can be used, thereby achieving a significant saving in masterbatch consumption.

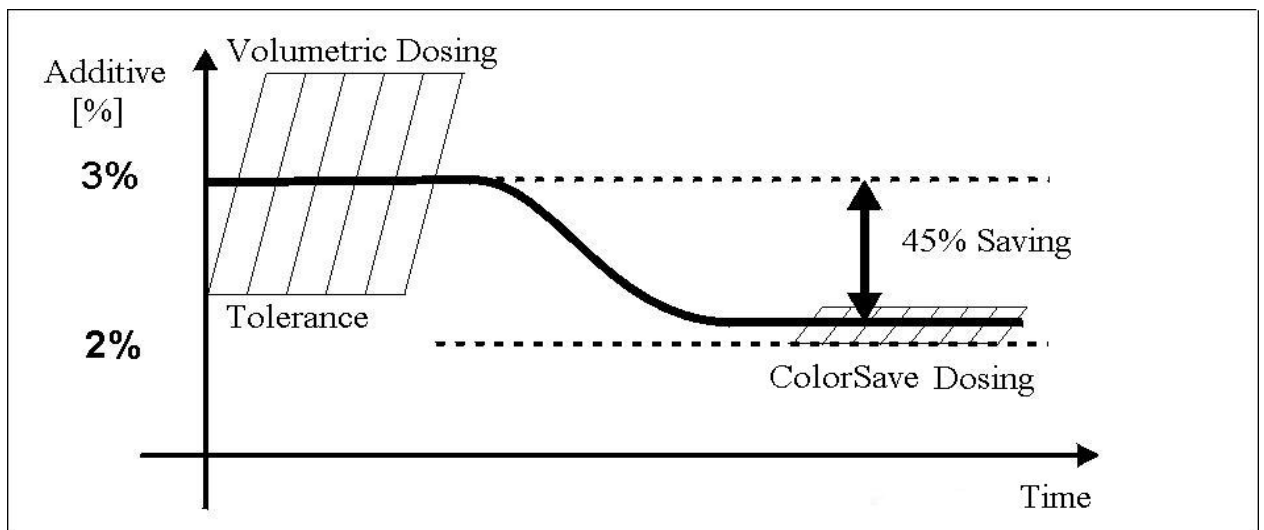

Economic considerations

The return on investment (ROT) rate is a function of the masterbatch cost (EUR/kg) and saving (%) level of the masterbatch.

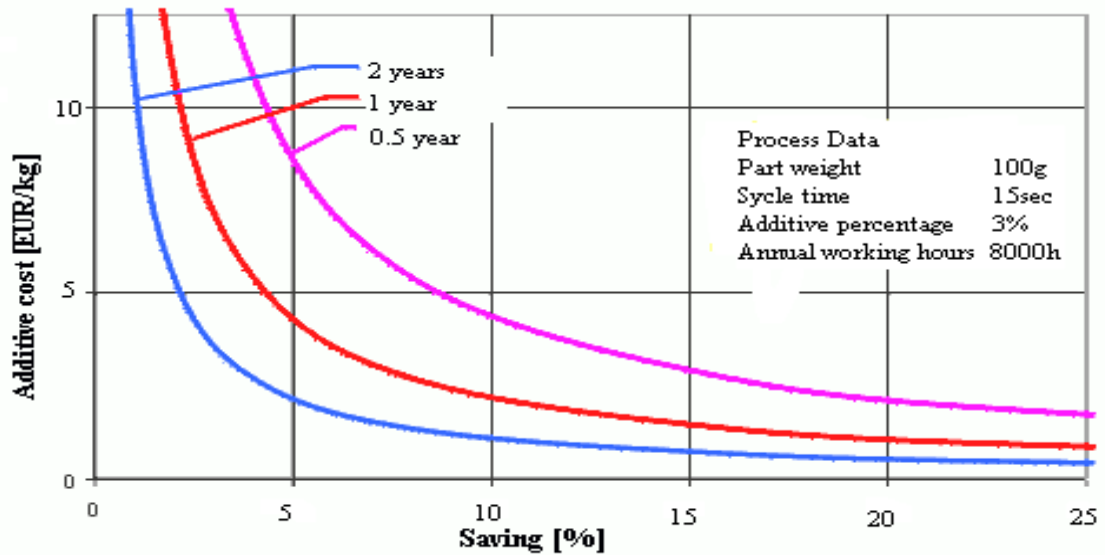

Technical Specifications

Feature	Specifications
Output range	0.1kg/hr – 40kg/hr Micro dosing option: 2-3 pellets per shot (for 0.7 gr./cm ³ bulk density)
	Loss-in-weight dosing. On-line metering and control of masterbatch/additive batches
Load cell	15 kg max., temp. compensated
Hopper	3 liter (5 liters optional)
Loader	Automatic integral venturi vacuum loader with integrated material no-fill alarm
Motor	110W powerful DC motor
Operation	Setting of desired masterbatch/additive percentage and shot weight Automatic setup and calibration
Weight	16 kg
Controller	Sophisticated powerful control unit, based on Siemens controller. Advanced control algorithm and software. RS-485 communication port (optional)
Input signal	Dry contact input for synchronization with injection cycle
Data recording	Accumulated number of injection cycles and masterbatch/additives weight as well as average percentage
Mounting and feeding	By neckpiece adapter, directly into the injection machine throat
Power	230v+/-10%, 200W, 50/60hz (115v optional)

and dimensions are subject to change without notice.

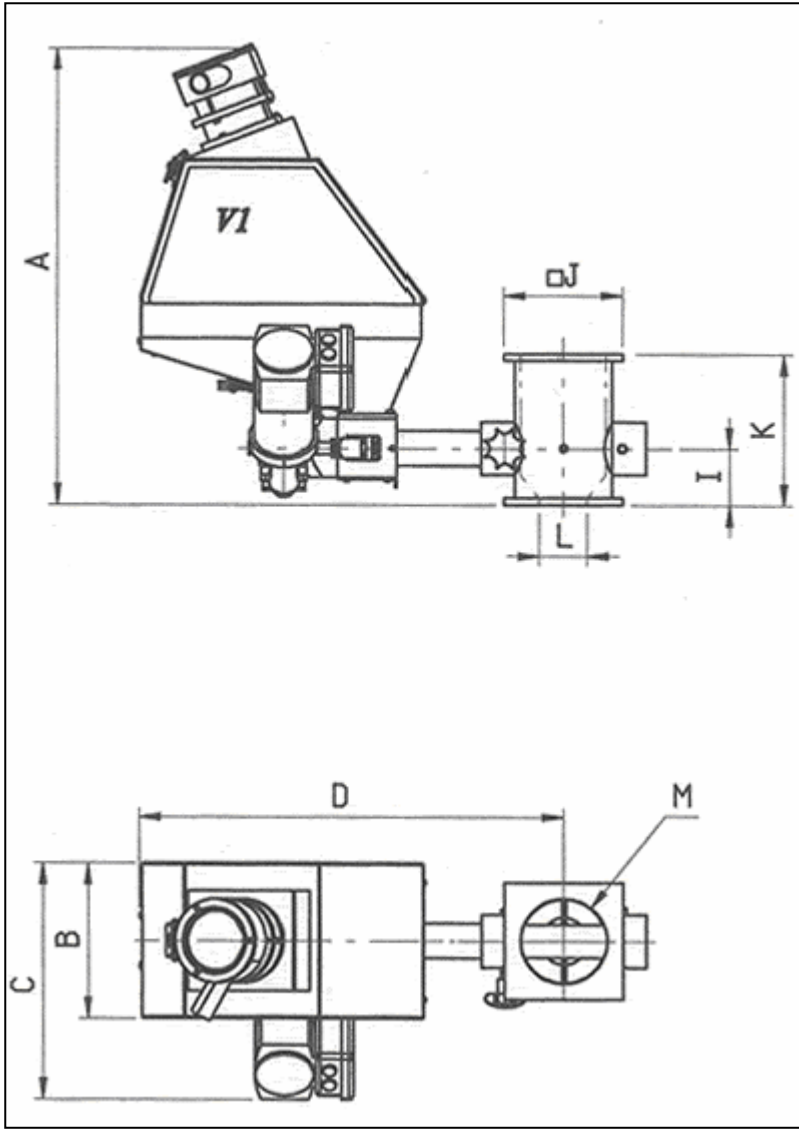

Dimensions	
A = 544 mm	J = 140 mm
B = 186 mm	K = 180 mm
C = 283 mm	L = ϕ 56 mm
D = 500 mm	M = ϕ 100 mm
I = 67 mm	

Volumes
V1 = 3 liter

The following alternative optional screws are available:

Micro capacity Dosing screw	1-2 pellets/shot – 0.2kg/hour
Low-capacity screw	0.1 kg/hr – 2.5 kg/hr
Medium-capacity screw	0.2 kg/hr – 10 kg/hr
High-capacity screw	0.4 kg/hr – 25 kg/hr
Extra-capacity screw	0.6 kg/hr – 40 kg/hr

Selection of the correct screw yields very high accuracy.